

## Violation & Remediation *Examples*

### Violation: FILL

Grass clippings

### Remedy:

Remove clippings & take to County Compost Site (Bunker Hills: 763.767.7964).



Mulch your lawn to save time and money (not in wetland since clippings = Fill!).

### Violation: FILL

Sand, landscaping ties, and equipment for playground

### Remedy:

Removal of playground area, and re-establishment of wetland vegetation in former



playground area before next mowing.

## Learn More!

[www.anokanaturalresources.com](http://www.anokanaturalresources.com)

[www.bwsr.state.mn.us/wetlands/publications/](http://www.bwsr.state.mn.us/wetlands/publications/)

[www.dnr.state.mn.us/wetlands/](http://www.dnr.state.mn.us/wetlands/)



### Credits

Coon Creek Watershed District staff

[www.bwsr.state.mn.us/wetlands/publications/](http://www.bwsr.state.mn.us/wetlands/publications/)

[www.dnr.state.mn.us/wetlands/](http://www.dnr.state.mn.us/wetlands/)

[www.state.va.us/dcr/dnh/ncPIIa.htm](http://www.state.va.us/dcr/dnh/ncPIIa.htm) (marsh marigolds)

[cstl-cla.semo.edu/finney/mlp/pics/monet.jpg](http://cstl-cla.semo.edu/finney/mlp/pics/monet.jpg) (Monet's "Japanese Footbridge")

## Water IQ #9

© 2013

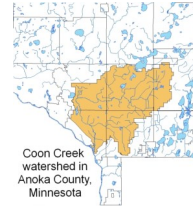

## Coon Creek Watershed District

12301 Central Ave. NE

Suite 100

Blaine, MN 55434

Telephone:

763.755.0975

[www.cooncreekwd.org](http://www.cooncreekwd.org)

Email: [info@cooncreekwd.org](mailto:info@cooncreekwd.org)

### Mission

*To manage groundwater and surface water drainage systems to prevent property damage, maintain hydrologic balance, protect water quality for the safety and enjoyment of citizens and preservation and enhancement of wildlife habitat.*

## Coon Creek Watershed District

## Water IQ #9

## Living with Wetlands

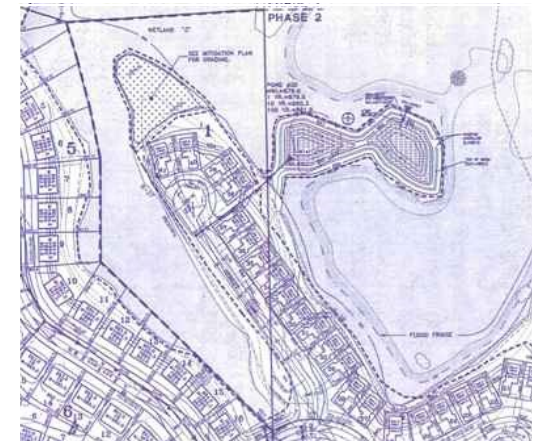

Ninth in a Water Information Quest (IQ) Series by Coon Creek Watershed District

Tel: 763.755.0975

# Wetlands

## The Myth...

Most people think of wetlands as open water ponds with lily pads or cattails and ducks.



## ...The Reality

A wetland may have no visible water for part, or all, of the year. Some have



trees and shrubs; some are farmed. Others are meadows, shrub swamps, bogs, & fens.

## Wetland Plants

Some wetland plants, like stinging nettles or reed canary grass, are often undesirable to people. It is legal to remove them and substitute with other wetland plants (without adding soil!) on your property. Ask for Technical Assistance from Coon Creek Watershed District (form on website, or call us) and check with your city. Here are a few suggestions:



New England Aster



Red-twig dogwood



Sawtooth Sunflower



Blue Vervain

# Benefits

Wetlands can...

- reduce flooding by slowing water runoff
- help us meet water quality requirements by filtering out sediments, nutrients, and toxic substances
- provide habitat for wildlife and plants
- provide opportunities for recreation such as canoeing, hunting, hiking, and birding
- be important outdoor science and art classrooms



## What You Can Do On Your Property

(or with written permission)



**R**emove fill from wetlands: grass clippings, leaves, brush, rock piles, trash, landscaping materials, and turf.

Why? The fill can compact the soil and reduce the filtering capacity of wetlands.

**C**ontact Coon Creek Watershed District for Technical Assistance (first 2 hours free) if you want to put in fill: Call 763.755.0975 or download a form at [www.cooncreekwd.org](http://www.cooncreekwd.org), Permit Applications.

# Legal-Ease

A permit is needed to excavate, drain, or fill any wetland. Why? The importance of wetlands for healthy water was recognized in the 1991 MN Wetland Conservation Act (WCA).

WCA calls for a 'no net loss' of wetlands so wetland draining, filling, & excavation activities need to be avoided or minimized and then offset by either wetland restoration or replacement (called "mitigation").

## What determines a wetland?

Legally, under *Normal\** circumstances, a wetland must meet 3 criteria:

1. Soil: hydric (wet, like peat, or black or gray sand)
2. Hydrology: saturated soil (water table within 12"), or standing water for at least 14 consecutive days in 5 of 10 normal years.
3. Vegetation: supports or is able to support plants adapted to saturated soil conditions.

*\*many Anoka County wetlands are not Normal and so require special criteria*

## Violations

Without a permit, the following are violations in wetlands:

- Adding Fill
- Draining
- Excavating

A Cease & Desist Order may be issued. A permit from Coon Creek Watershed District (CCWD) is required within the CCWD boundary. See maplink on our homepage: [www.cooncreekwd.org](http://www.cooncreekwd.org)

Outside CCWD and within Anoka County, contact the Anoka Conservation District (763.434.2030)