

**COON CREEK WATERSHED DISTRICT
Request for Board Action**

MEETING DATE: February 12, 2024
AGENDA NUMBER: 12
ITEM: SP 0208-165

AGENDA: Permit

BACKGROUND/DISCUSSION

The purpose of this agenda item is for the Board to review, discuss, and consider approving Permit Application Number P-23-079 SP 0208-165.

RECOMMENDATION

To approve Permit Application Number P-23-079 with 2 conditions and 1 stipulation, as stated in the Application Review Report dated 2/08/2024.

ATTACHED

Application Review Report for Permit Application Number P-23-079

Permit Application Review Report
Date: 2/8/2024

Applicant/Landowner:

MNDOT
Attn: Corey Mueller
1500 County Rd B-2 West
Roseville, MN 55113

Project Name: SP 0208-165

Project PAN: P-23-079

Project Purpose: Replacement of numerous culverts, temporary road surface improvements and the replacement of the Hwy 65 bridges over Coon Creek with culverts.

Project Location: Highway 65 from approximately CSAH 10 through northern boundary of Coon Creek Watershed District

Site Size: size of parcel - 8.26 acres; size of disturbed area - 8.26 acres; size of regulated impervious surface - 0 acres.

Applicable District Rule(s): Rule 2, Rule 4, Rule 6, Rule 7, Rule 8

Recommendation: Approve with 2 Conditions and 1 Stipulations

Conditions to be Met Before Permit Issuance:

Rule 2.7 – Procedural Requirements

1. Submittal of a performance escrow in the amount of \$6,130.00.

Rule 7.0 – Drainage, Bridges, Culverts, and Utility Crossings

2. Please provide a temporary stream by-pass/dewatering plan that includes the following:
 - a. Plan and details for diverting flow around the work area during construction.
 - b. Plan should include necessary erosion control/stabilization measures to prevent scour and erosion within, immediately upstream, and immediately downstream of the temporary by-pass and work area.
 - c. By-pass capacity – provide calculations to show that the temporary by-pass is capable of conveying flows from at least the 10-year storm event.
 - d. Specify duration and timeframe that the by-pass will be in place.
 - e. If dewatering of the work area is required, provide dewatering discharge plan including location of discharge and erosion control measures to prevent erosion and scour in the vicinity of the discharge locations.

Stipulations: The permit will be issued with the following stipulations as conditions of the permit. By accepting the permit, the applicant agrees to these stipulations:

1. Submittal of as-built (invert, culvert size) for culvert installation within Coon Creek.

Exhibits:

Exhibit Type	Exhibit Author	Signature Date	Received Date
Construction and Drainage Plans	MnDOT	12/15/2023	12/27/2023

Findings

Description: The project scope is proposed largely in preparation for an upcoming large road project along the same corridor. This project includes in-kind replacement and repairs to existing culverts along HWY 65 from CSAH 10 through the northern boundary of the Coon Creek Watershed District, construction of temporary new road surfaces, and the replacement of the bridge over Coon Creek with culverts. The total project disturbance is 8.26 acres. There is no permanent new or reconstructed impervious proposed. See Figure 1: Site Plan (attached).

Fees and Escrows (Rule 2.7): The applicant is a government agency and is therefore exempt from an application fee or a review and inspection fee deposit. The applicant will be required to submit a performance escrow in the amount of \$6,130.00. This corresponds to a base escrow of \$2,000, plus an additional \$500/acre of disturbance (8.26 acres of land disturbance proposed).

Stormwater Management (Rule 3.0): The proposed project does not create a cumulative total of 10,000 sf or more of new or fully reconstructed impervious surface, or 5,000 sf or more of new or fully reconstructed impervious surface for non-residential or multifamily residential within one mile of and draining to an impaired water. The proposed project is not a public linear project where the sum of the new and fully reconstructed impervious surface is equal to one or more acres. Stormwater Management standards do not apply.

Soils and Erosion Control (Rule 4.0)

Rule 4.0 applies to the proposed project because is a land disturbing activity that requires a permit under another District Rule.

Minor portions of work take place within several subwatersheds. The bridge replacement portion of this scope of work is located within Coon Creek. The soils affected by the project include Zimmerman and Seelyeville. Disturbed areas are proposed to be stabilized within 7 days, as required. The proposed erosion and sediment control plan includes perimeter control, rip rap, and seeding. The erosion control plan meets District Requirements. See Figure 2: Erosion & sediment control plan (attached).

Wetlands (Rule 5.0)

Wetlands exist on site, but no impacts are proposed. Rule 5.0 does not apply.

Floodplain (Rule 6.0)

Rule 6.0 applies to the proposed project because it includes land disturbing activities within or adjacent to the boundary of the 100-year flood elevation as mapped and modeled by the District. The regulatory floodplain elevation is 883.6 ft MSL. The application proposes the placement of approximately 30 cubic yards of fill within the floodplain. This a one-time deposition of less than 50 cubic yards, therefore compensatory storage is not required.

Drainage, Bridges, Culverts, and Utility Crossings (Rule 7.0)

Rule 7.0 applies to the proposed project because it includes land disturbing activities which construct, improve, repair, or alter the hydraulic characteristics of a bridge profile control or culvert structure on a creek, public ditch, or major watercourse.

The regulated waterway is Coon Creek (County Ditch 59). The banks of the waterway have been proposed to be stabilized with permanent vegetation mix 35-221.

The culvert provides equivalent hydraulic and navigational capacity to existing conditions. An analysis was provided by the State Waterway Engineer and verified through review with the District

Model. The applicant has worked in coordination with the MnDNR to incorporate biota passage design features. This is consistent with MnDOT's Minnesota Guide for Stream Connectivity and Aquatic Organism Passage Through Culverts.

Buffers (Rule 8.0)

The proposed project includes land disturbing activity on land in and adjacent to a Public Ditch. Existing buffers adjacent to the public ditch will be left intact.

Variances (Rule 10.2)

The proposed project is not requesting a variance from the District's rules, regulations, and policies. Rule 10.2 does not apply.

P-23-079



2/6/2024

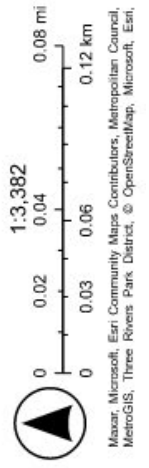

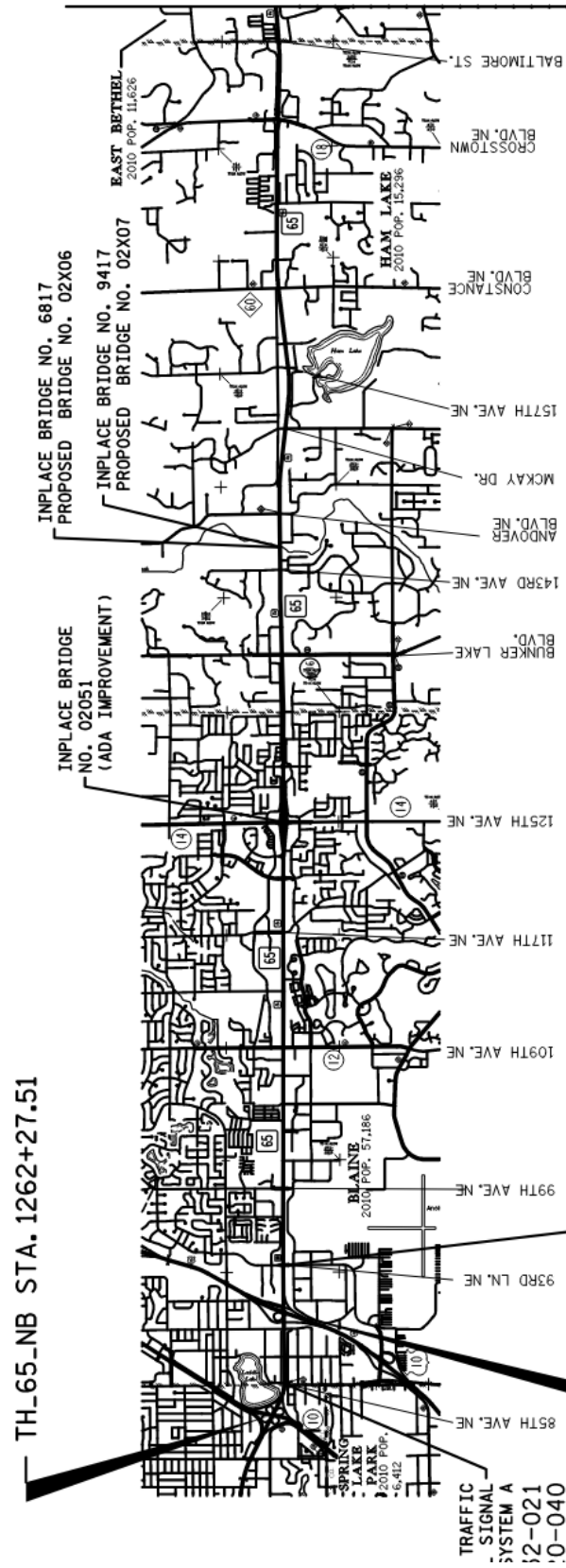

Figure 1: Site Plan

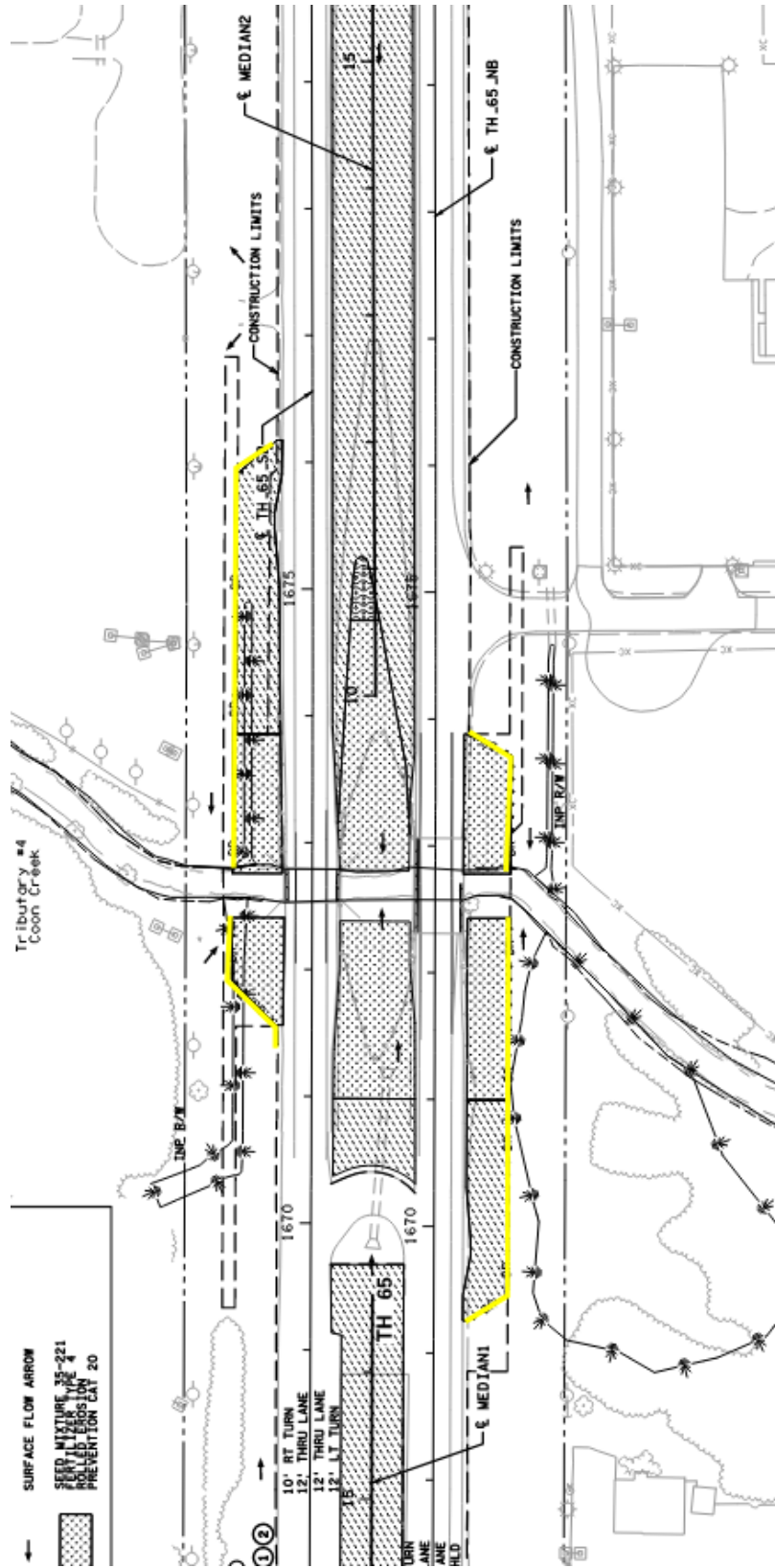

Figure 2: Erosion and Sediment Control Plan